

# Assembly & Installation Instructions: Sierra 2-Leg Desk SEHX30-48-XXX-XX-X

## Parts Included

**A** Leg  
Qty: 2

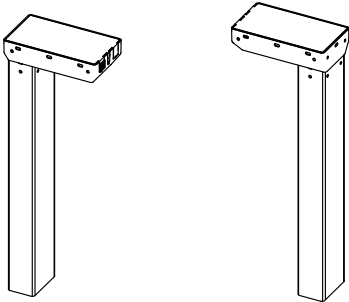

**B** Short Bracket  
Qty: 4



**C** Left End Bracket  
Qty: 1



**D** Right End Bracket  
Qty: 1



**E** 4 mm Allen Wrench  
Qty: 1



**F** #M6 × 14 mm Flat Head Cap  
Screw  
Qty: 20



**G** #12 × ¾" Pan Head Laminate  
Top Screw  
Qty: 22



**H** Foot Glide  
Qty: 4



**I** Control Box  
Qty: 1

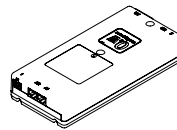

**J** #12 × 2" Flat Head Screw  
Qty: 2



**K** Cable Spool  
Qty: 2



**L** #8 × ⅝" Pan Head Screw  
Qty: 12



**M** ⅜" Cable Loops  
Qty: 10



**N** Leg Cable, 1  
meter  
Qty: 2

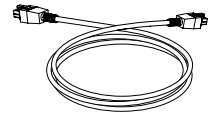

**O** Power Cord  
Qty: 1

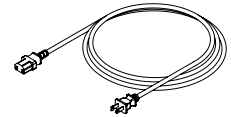

**P** Style or Flat Foot Kit  
Qty: 1

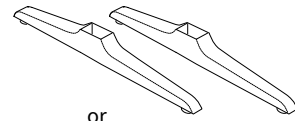

or

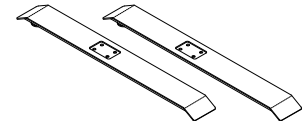

**Q** Standard or  
Programmable Switch  
Qty: 1

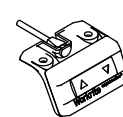

or

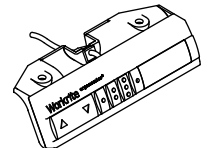

**Sold Separately:**  
Worksurface

**! WARNING:** Maximum loading of table assembly is 225 lb (102 kg). Maximum load includes the weight of the table top itself, any equipment placed upon it, and any equipment suspended or hanging under it. Loading should be evenly distributed over table surfaces. "Payload Capacity" is the Workrite Ergonomics recommended maximum loading which includes the Workrite sourced worksurface.

**Sierra 2-Leg**

V = 120 VAC, 60 Hz / 4.25 A maximum

**FLAMMABILITY:** All worksurfaces used must meet UL962 flammability requirements

- Flame Spread Rating maximum 200
- Smoke Developed Index maximum 450

**WORKSURFACE SIZE:** This frameset is designed to accommodate worksurfaces made from Industrial Particle Board with the following dimensions:

<b>Dimensions (inches):</b>	
Rectangles:	34"-46" w x 23"-29" d
Small Equal Corners:	40"-46" w x 23"-29" d
120 Degree Corner:	34"-46" wL x 34"-46" wR x 23"-29" d

**IMPORTANT SAFETY INSTRUCTIONS:**

When using an electrical furnishing, basic precautions should always be followed, including the following:  
Read all instructions before using this Sierra Work center.

**DANGER:** To reduce the risk of electric shock, always unplug this Sierra Work center from the electrical outlet before cleaning.

**! WARNING:** To reduce the risk of burns, fire, electric shock, or injury to persons:

1. Unplug from outlet before putting on or taking off parts.
2. Close supervision is necessary when this furnishing is used by, or near children, invalids, or disabled persons.
3. Use this furnishing only for its intended use as described in these instructions. Do not use attachments not recommended by the manufacturer.
4. Never operate this furnishing if it has a damaged cord or plug, if it is not working properly, if it has been dropped or damaged, or dropped into water. Return the furnishing to a service center for examination and repair.
5. Keep the cord away from heated surfaces.
6. Do not use outdoors.
7. Do not operate where aerosol (spray) products are being used or where oxygen is being administered.
8. To disconnect, remove plug from outlet.
9. Each surface intended to support an equipment payload capacity of 225 pounds.

**FOR COMMERCIAL USE ONLY**

**SAVE THESE INSTRUCTIONS**



**IMPORTANT NOTE!**

**You must complete initialization (Step 13) at the end of assembly or your work center WILL NOT FUNCTION PROPERLY.**

## ✓ Verify that you have all the tools needed for the assembly

You will need the following tools:

#2 tip Phillips screwdriver or drill/driver  
#3 tip Phillips screwdriver or drill/driver  
M4 tip bit or 4 mm Allen Wrench (E)

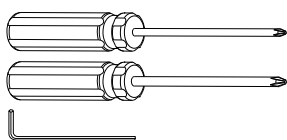

or

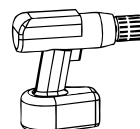

If you do not have a Workrite worksurface, you will also need:

1/8" pilot drill bit



3/32" pilot drill bit



## 1 Attach Brackets to Legs

**1.1** Attach Short Brackets (B) using #M6 × 14 mm Flat Head Cap Screws (F) to both legs.

**1.2** Attach Left End Bracket (C) and Right End Bracket (D) to sides of the Leg (A) using #M6 × 14 mm Flat Head Cap Screws (F).

**Note:** The Right End Bracket will be on your left and vice versa when the assembly is seen upside down.

**Tighten securely.**

**!** To avoid stripping the threads, always insert and make the first few turns of the screw **BY HAND** with an Allen wrench (E), ensuring it is in straight.

Hardware at actual size

**F** #M6 × 14 mm Flat Head Cap Screw

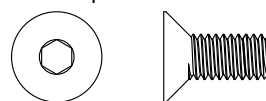

### Caution!

Only use the #M6 × 14 mm Flat Head Cap Screw (F) for assembly.

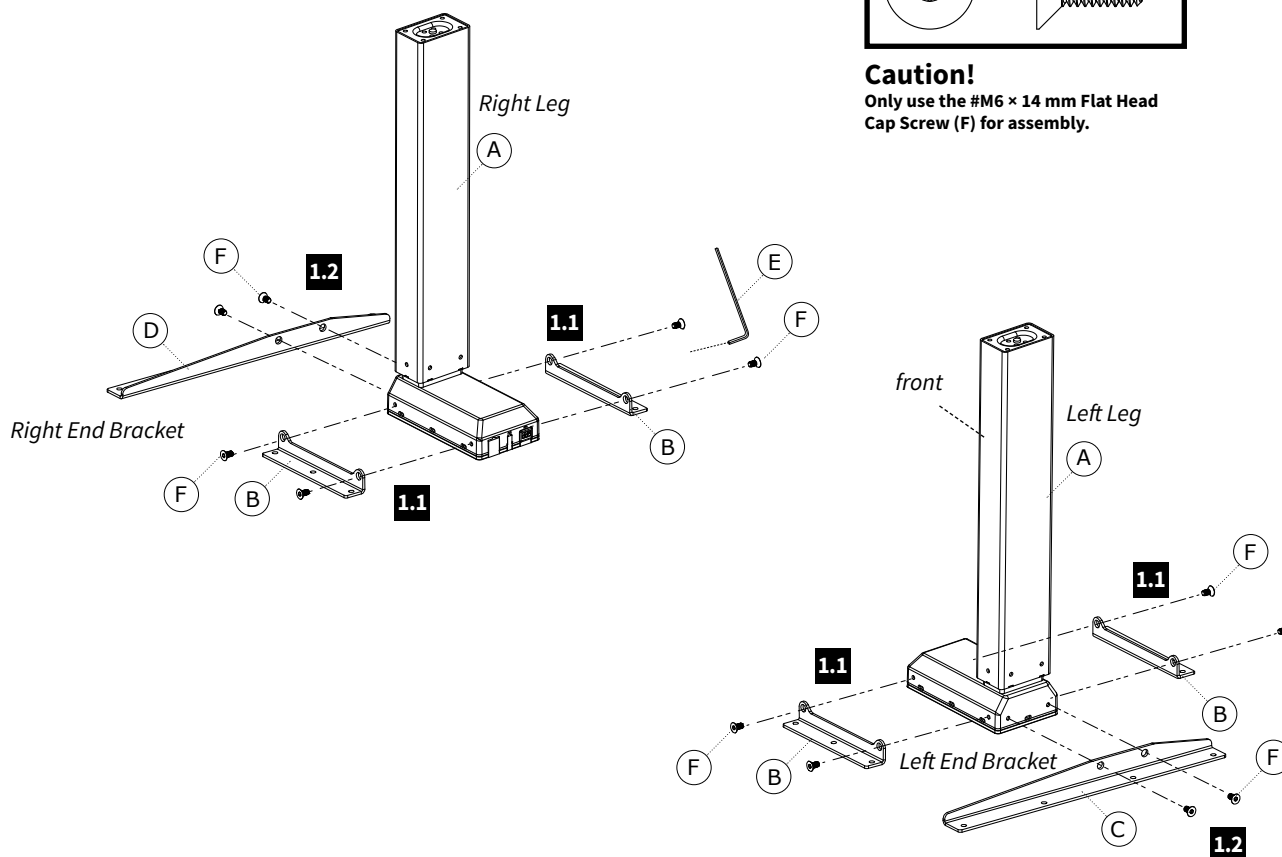

## 2 Attach Base to Worksurface

**Note:** For 2-Leg Corner and 120° Worksurface Mounting Instructions, go to:

[www.workriteergo.com/instructions](http://www.workriteergo.com/instructions)



**Note: Avoid trip or tip hazards!**

For uniquely shaped, non-rectangular worksurfaces, it is the installer's responsibility to position the worksurface to minimize extended overhangs and position feet fully under the worksurface.

- 2.1** Position Leg Assembly 2.875" from the sides and 6.125" from the front of the worksurface, making sure the legs are parallel with the back edge of the worksurface

- 2.2** Use a 1/8" drill bit to drill pilot holes at the four corner locations. You may wish to mark your drill bit so you do not drill any more than 3/4" deep and damage your worksurface top. **Do not drill all the way through worksurface!**

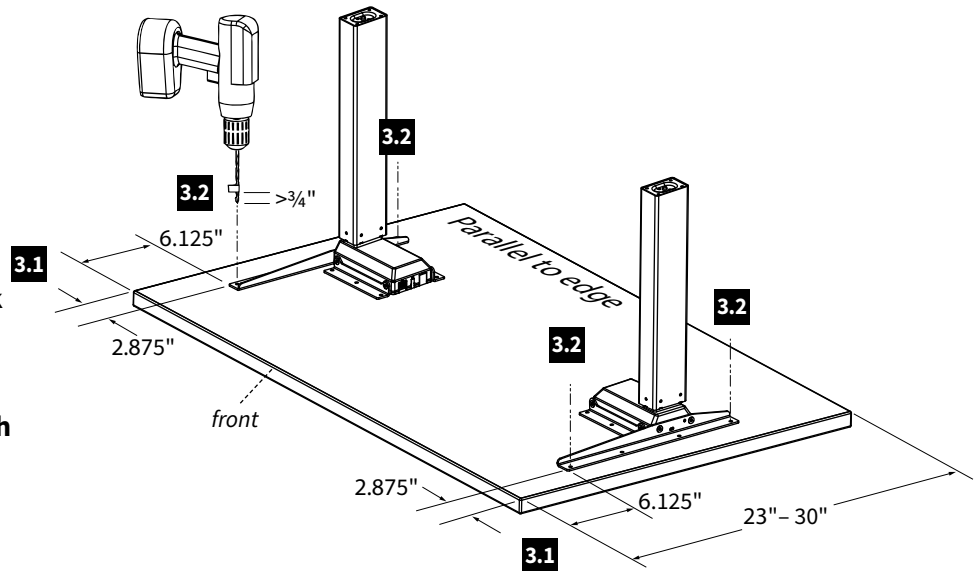

Hardware at actual size

**G** #12 × 3/4" Pan Head  
Laminate Top Screw

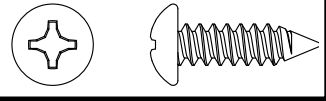

- 2.3** Attach at the four corner locations using #12 × 3/4" Pan Head Laminate Top Screws (G). If you use an electric screwdriver, be sure it is on the lowest torque setting to avoid stripping the holes in the top.

- 2.4** With frame set positioned and the four corner screws secure, drill all remaining pilot holes first then install all remaining #12×3/4" Pan Head Laminate Top Screws (G). **Do not drill all the way through worksurface!**

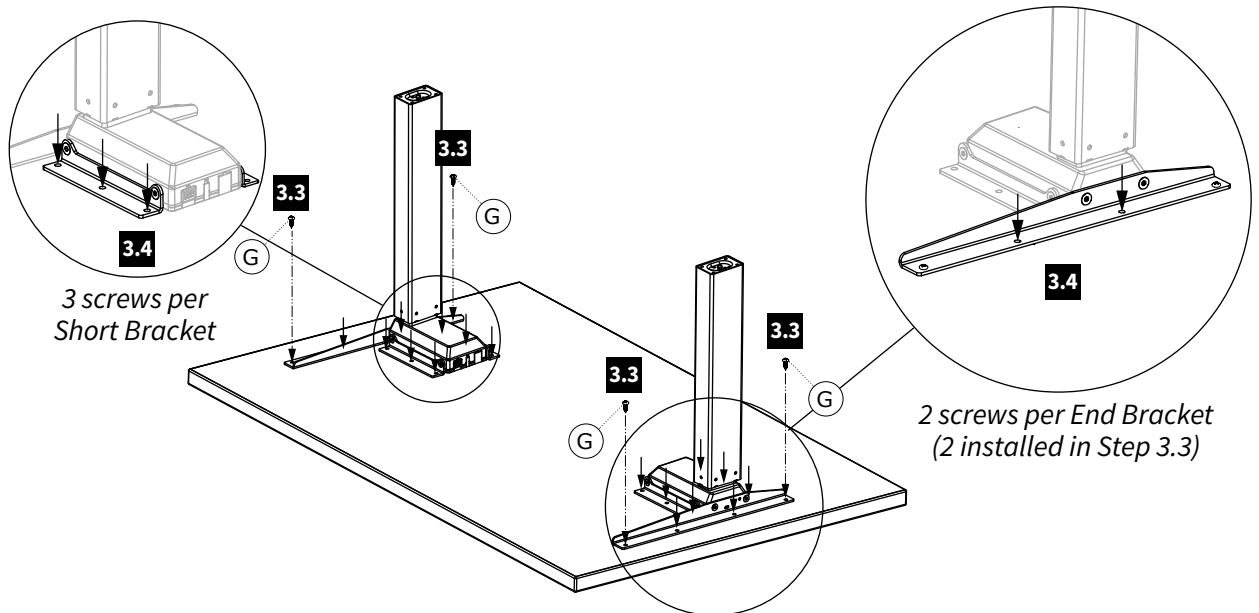

### 3 Attach Feet & Install Foot Glides

- 3.1 Install Feet (P) using #M6 × 14 mm Flat Head Cap Screws (F) included with this Frame Set.
- 3.2 Attach Foot Glides (H) to bottom of the Feet supplied in your Foot Kit.

Hardware at actual size

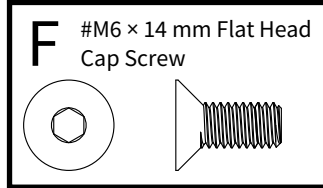

#### Caution!

Only use the #M6 × 14 mm Flat Head Cap Screw (F) for assembly.

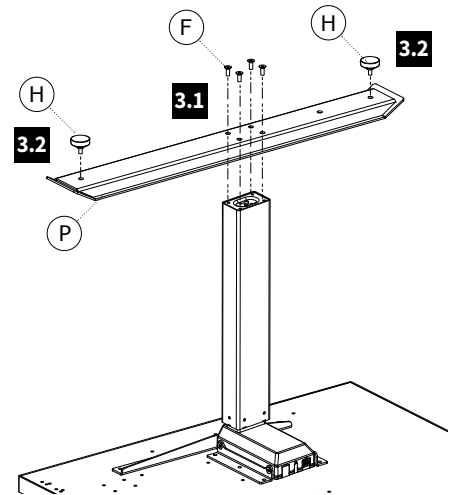

Flat Foot shown

### 4 Attach Switch (Packaged Separately)

- 4.1 Using the dimensions shown place the Switch (Q) on the desktop
- 4.2 Using a Drill and a  $\frac{3}{32}$ " drill bit, drill the two switch mounting holes as shown.
- 4.3 Attach the Switch (Q as shown with two (2) #8 ×  $\frac{5}{8}$ " Pan Head Screws (L)

Hardware at actual size

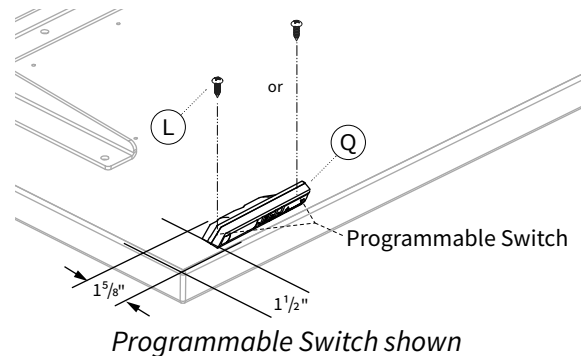
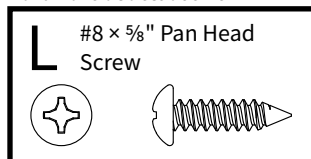

**Note:** The Switch (Q) can be located on the Right or Left side of the table as required.

### 5 Loop Power Cord through Strain Relief on Control Box

- 5.1 Loop the Power Cord (O) through the strain relief channel on the bottom of the Control Box (I) as shown. Leave eight inches of slack to route cord.
- 5.2 Plug Power Cord (O) into power outlet AC on the Control Box (I).
- 5.3 Lay the Control Box down in installation location with cables in place.

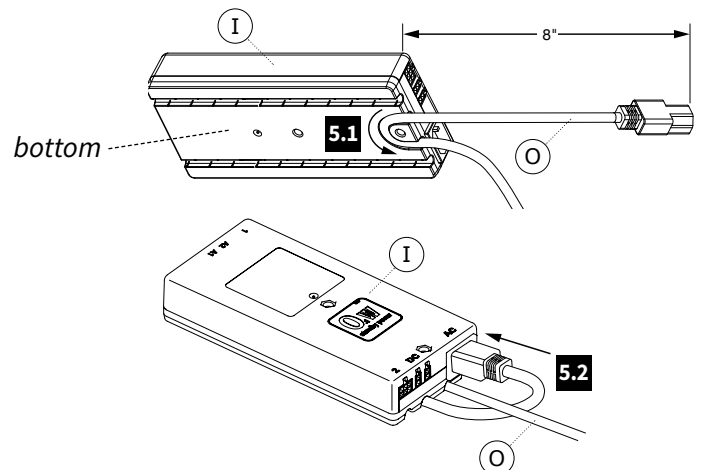

## 6 Attach Control Box & Cable Spools to Worksurface

- 6.1** Place Control Box (I) in position and use a pencil to mark pilot hole placement. Control Box should be placed towards rear center of worksurface as shown. Remove Control Box and drill pilot holes where marked.

**Do not drill all the way through worksurface!**

- 6.2** With Control Box (I) positioned over pilot holes, attach with two #12 × 2" Flat Head Screws (J).
- 6.3** Attach Cable Spool (K) with the #12 × ¾" Pan Head Screw (G) to underside of worksurface. If you do not have a Workrite worksurface, mount Cable Spools (K) in a convenient location between Legs and Control Box.
- 6.4** Lay out Leg Cables (N) to be sure they reach from the Legs (A) to the Control Box (I).

### 48" Tables

Hardware at actual size

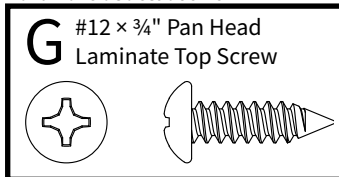

Hardware at actual size

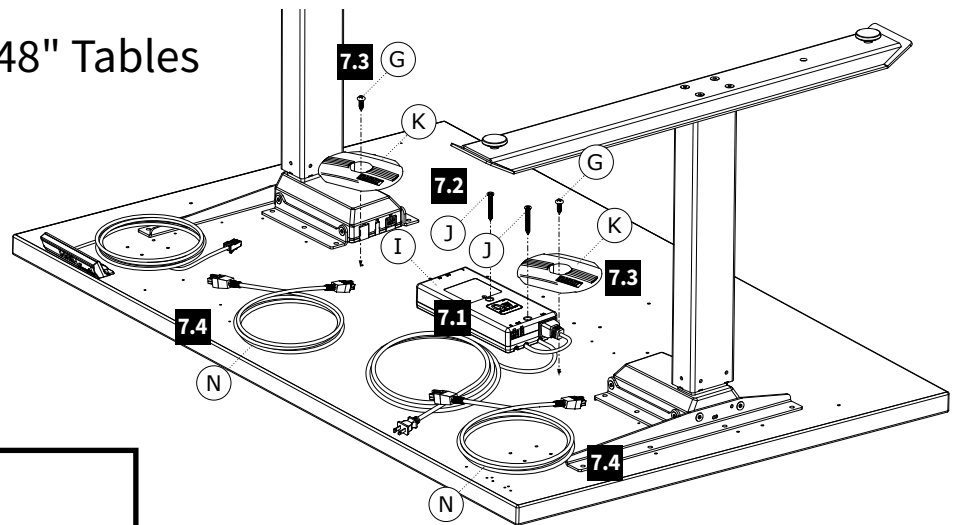
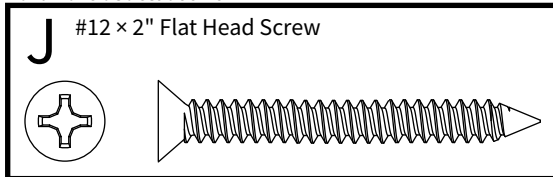

### 32" & 40" Tables

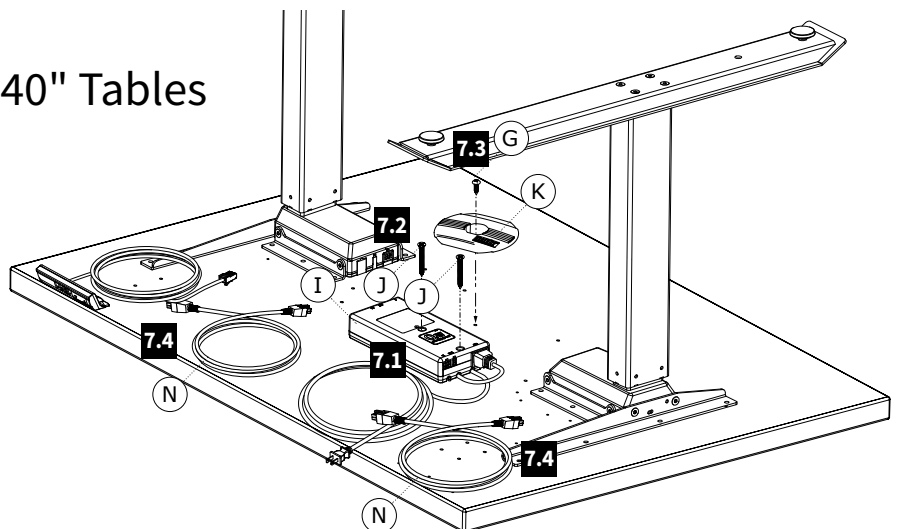

## 7 Attach Cable Loops and Route Cables

- 7.1 Connect both of the 1 meter Leg Cables (N) to both Legs (A).
- 7.2 Wind any remaining slack around Cable Spools (K) to keep cables out of the way while leaving enough slack to just reach the Control Box (I).
- 7.3 Attach Cable Loops (M) to underside of worksurface using #8 × 5/8" Pan Head Screw (L) making sure to wrap the Cable Loop around the cable prior to attaching. Attach cable loops in convenient locations between Legs or Switch and the Control Box.

Hardware at actual size

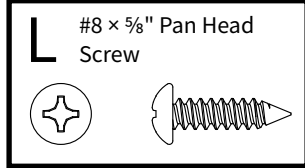

### 48" Tables

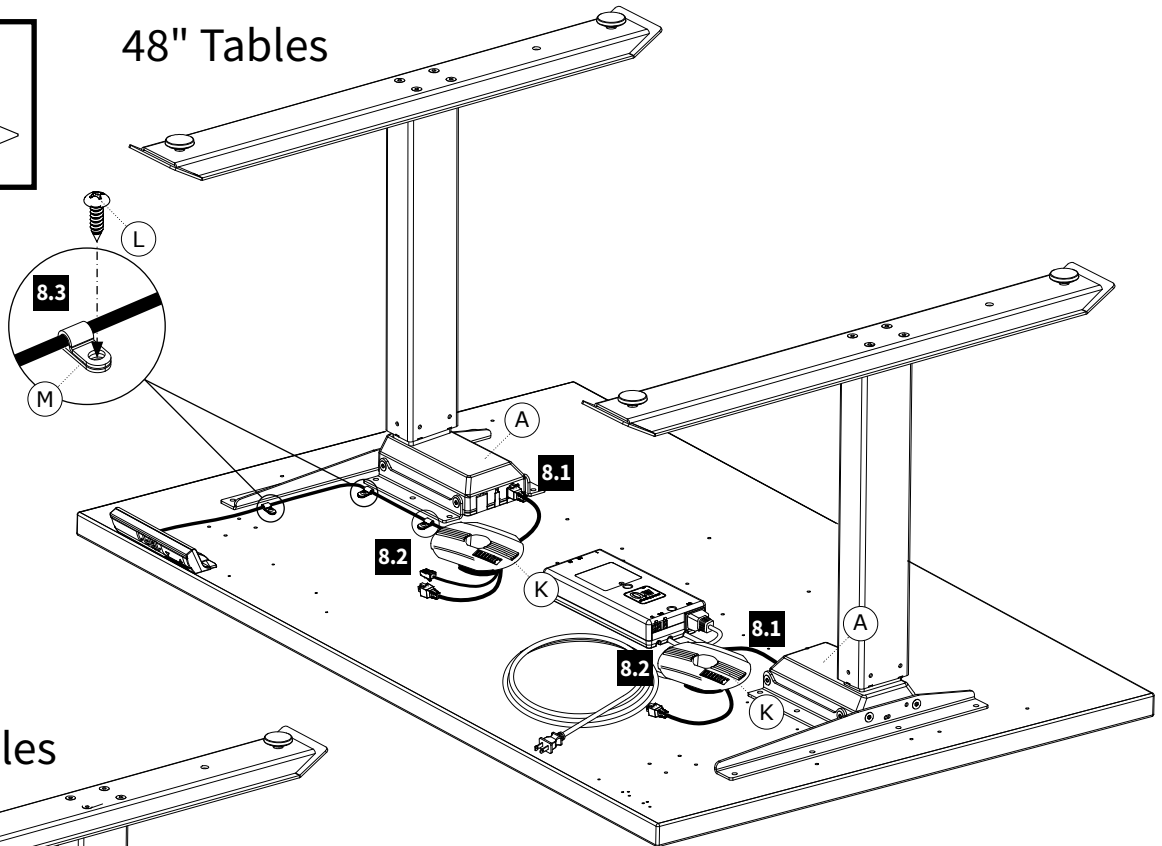

### 32" & 40" Tables

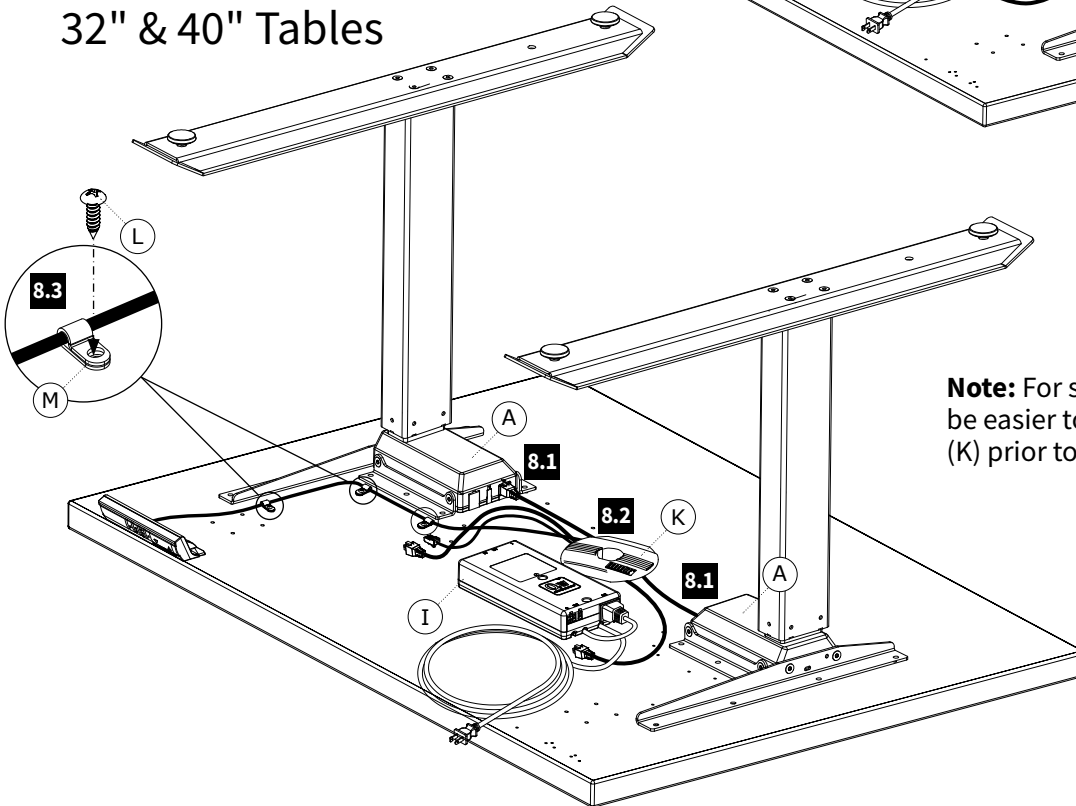

**Note:** For smaller work centers, it may be easier to wrap cable around Spools (K) prior to plugging into Legs (A).

## 8 Connect Leg Cables, Switch Cable and Power Cord to Control Box

**8.1** Connect the Leg Cables (N) into ports “1” & “2” on both sides of the Control Box (I).

**8.2** Insert the Switch Cable into port “A1” on the Control Box (I).

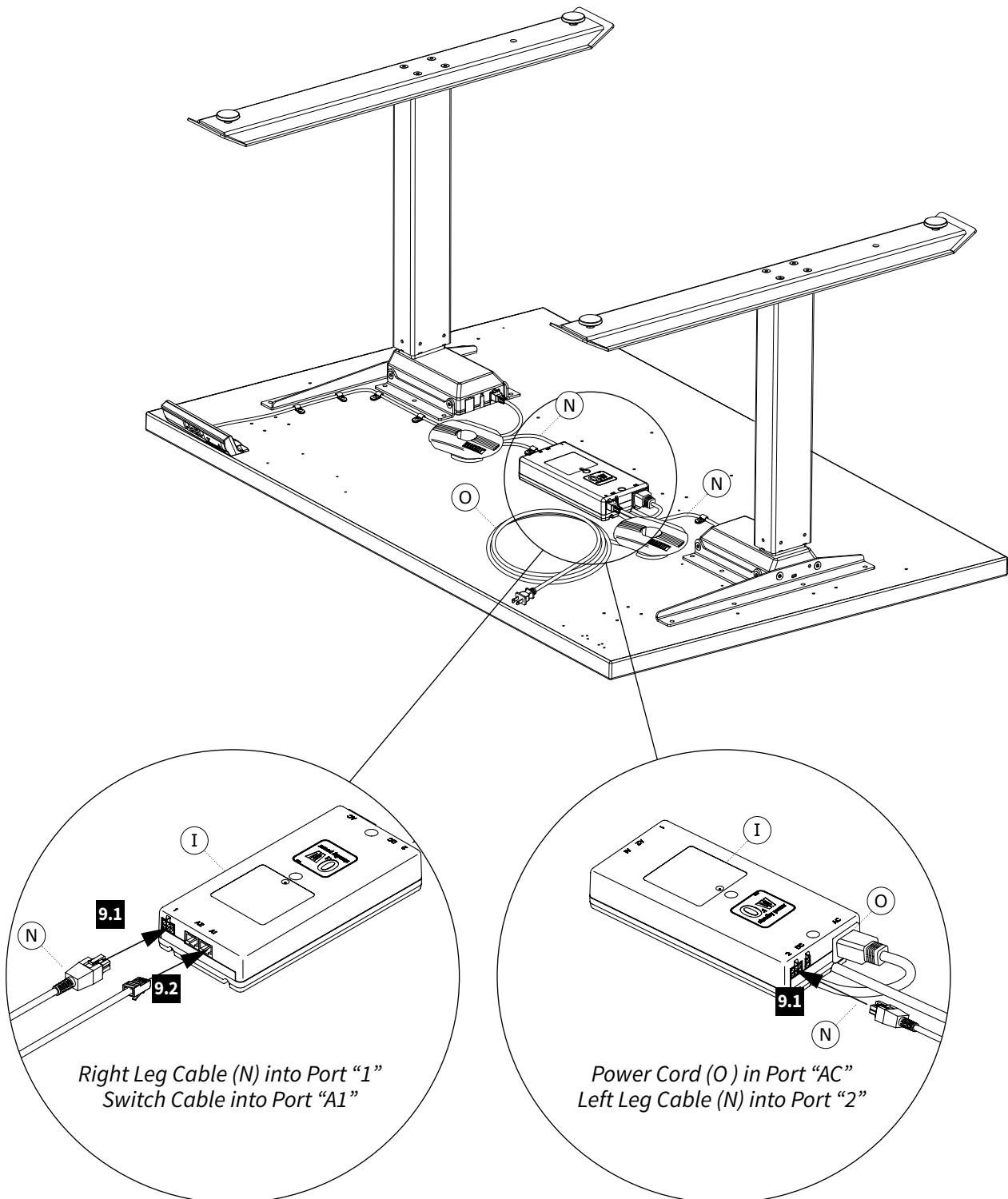



## 9 Put Work Center Upright and Connect Power Cord to the Power Supply

9.1 Turn the work center over into an upright position.

**CAUTION!** Always use at least two people to flip and move work centers.

9.2 Plug the Power Cord (O) into the power outlet.



11.1

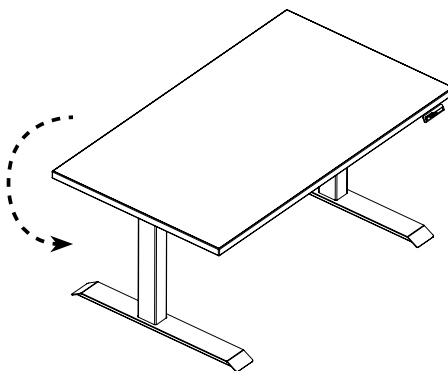

11.2

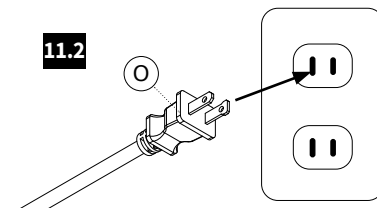

## 10 Adjust Feet Glides

If necessary, adjust the Foot Glides (H) on work center feet to level the worksurface. Unscrew to increase height, screw in to decrease height.

## 11 Initialize Legs

After all Legs and the Switch are connected, and the power cord has been plugged in, hold the **down arrow** on the Switch until the Legs make a short motion down and then back up. This initializes and synchronizes the work center Legs.

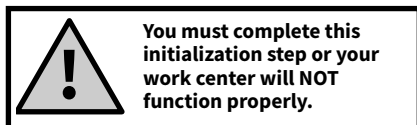

**Hold down the down arrow  
until work center moves  
slightly upwards!**

## ✓ Cleaning Instructions

To clean the Sierra legs, apply cleaner to a soft cloth.

Suggested cleaners: Windex or Formula 409.

Do not use solvents and do not saturate or spray cleaners directly onto work center base.

## ✓ Parts & Accessories

Visit [http://workriteergo.com/documentation/other/workrite\\_ergonomics\\_pricing\\_specification\\_guide.pdf](http://workriteergo.com/documentation/other/workrite_ergonomics_pricing_specification_guide.pdf) for replacement parts.